

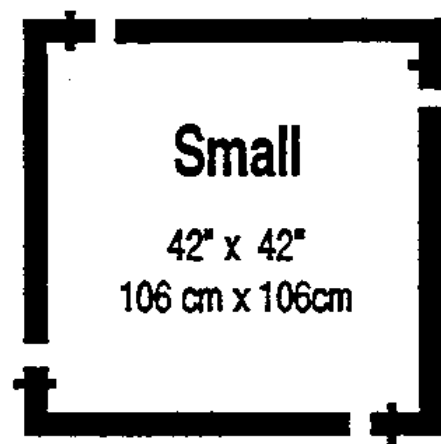

BY

**westcott®**

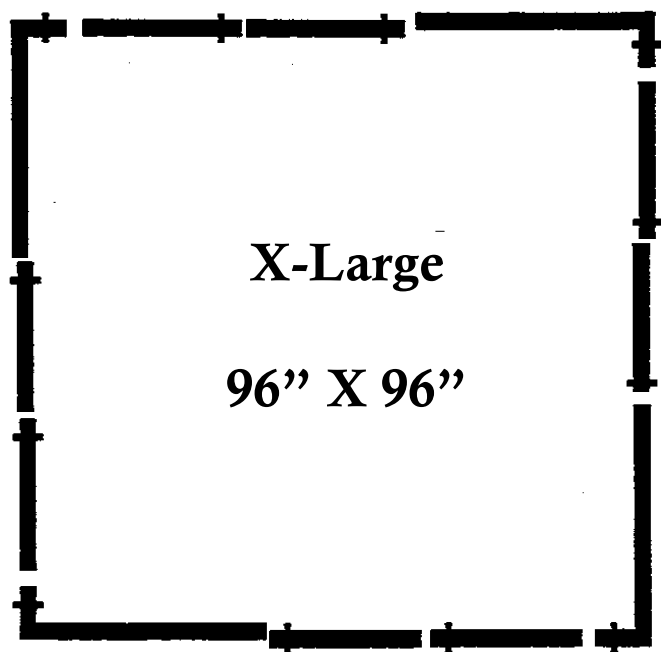
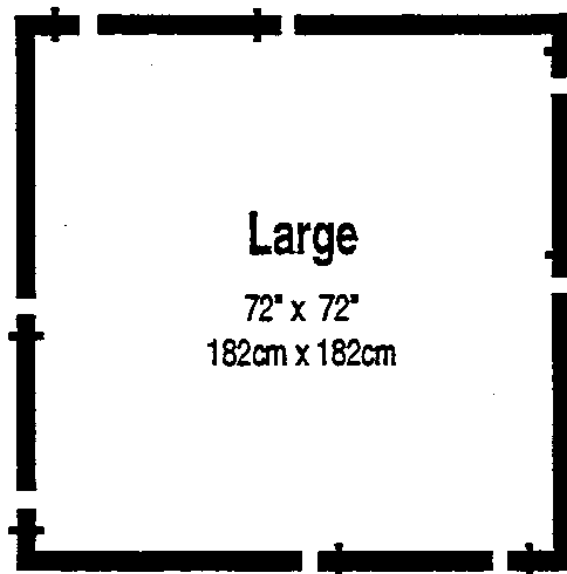
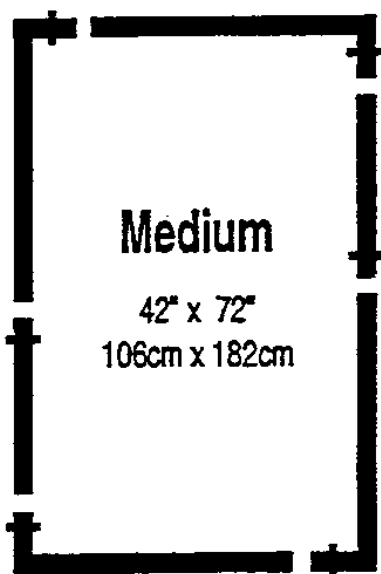

**Frame Assembly:**

- Small – 4 Corner Pieces
- Medium – 4 Corner Pieces  
2 Extensions
- Large – 4 Corner Pieces  
4 Extensions
- X-Large – 4 Corner Pieces  
8 Extensions

**Fabric Attachment:**

1. Attach all four Velcro corner tabs securely
2. Connect velcro around perimeter

**Re-packing Frame:**

1. Build 2 layers (as shown below)
2. Place one on top of the other, velcro to velcro

